

## DUPLEXbase PT Range Filter Maintenance Guide

**MVHR (Mechanical Ventilation with Heat Recovery)** units require regular filter maintenance (cleaning or replacement). The Airflow MVHR units have been designed to facilitate convenient access to the filters with easy maintenance in mind. The Airflow filters are tested and compliant with ISO 16890. This filter replacement guide is specific for the following products:

Product no	Description
90001425	DUPLEXbase PT 500
90001426	DUPLEXbase PT 900
90001427	DUPLEXbase PT 1800
90001428	DUPLEXbase PT 2800
90001429	DUPLEXbase PT 3500

Before opening the MVHR unit's door for cleaning, filter replacement or general maintenance always make sure that the equipment is disconnected from the mains power supply and prevent its reconnection to the mains by another person.

### Filter replacement indication

Replacement is carried out depending on the dust load of the external and internal environment and the subsequent contamination of filters and an increase in air resistance indicated by the differential manostats every 500 to 2000 running hours.

For units equipped with RD5 control system, CP Touch Controller part no: 90000710.



The unit is supplied with filters, individually packed (usually located on top of the units). Locate and unpack the filters. Install the filters in their allocated locations inside the unit.

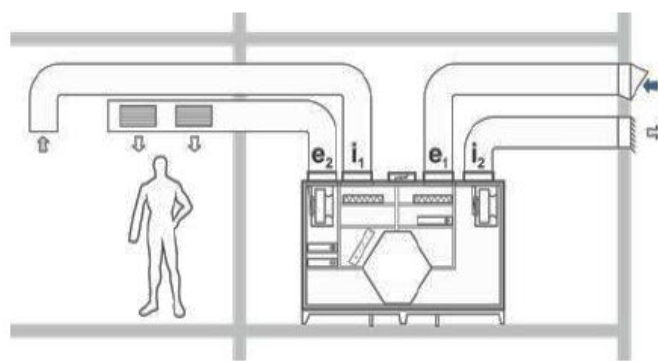
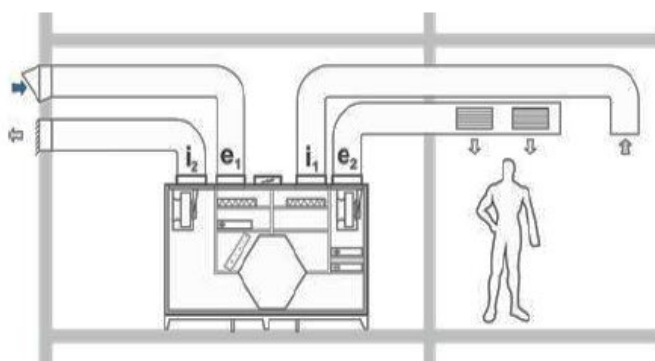

- i1 (ETA) = extract air filter
- i2 (EHA) = exhaust air
- e1 (ODA) = outdoor air filter
- e2 (SUP) = supply air

Should any damage or contamination be detected, replace the filters with new ones. Insert undamaged clean filters into the guide rails and secure them.

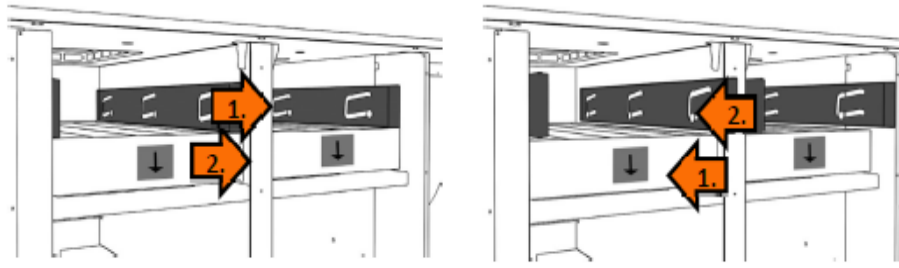

Make sure that the arrow showing the direction of air flow through the filter can be seen from the front view (the arrow is by the unit's door) and that the arrow always points towards the heat recovery exchanger.

The unit is supplied with filter labels unattached. Attach the relevant identification labels near the filters (e.g. on the relevant unit door).

Using original filters ensures that the ventilation unit has high performance. Record the date of filters replacement appropriately e.g. in the operational logbook.

Product no	Description	Dimensions (mm)	Pcs required/unit
90001663	PT 500 ePM10 50% (M5) Spare Filter - DUPLEXbase PT 500 (1 pc)	542 x 168 x 47	1
90001662	PT 500 ePM1 55% (F7) Spare Filter - DUPLEXbase PT 500 (1 pc)	542 x 168 x 47	1
90001670	PT 900 ePM10 50% (M5) Spare Filter - DUPLEXbase PT 900 (1 pc)	623 x 199 x 47	1
90001669	PT 900 ePM1 55% (F7) Spare Filter - DUPLEXbase PT 900 (1 pc)	623 x 199 x 47	1
90001981	PT 1800 ePM10 50% (M5) Spare Filter - DUPLEXbase PT 1800, 3500 (1 pc)	600 x 440 x 96	1
90001980	PT 1800 ePM1 55% (F7) Spare Filter - DUPLEXbase PT 1800, 3500 (1 pc)	600 x 440 x 96	1
90001842	PT 2800 ePM10 50% (M5) Spare Filter - DUPLEXbase PT 2800 (1 pc)	1000 x 440 x 96	1
90001841	PT 2800 ePM1 55% (F7) Spare Filter - DUPLEXbase PT 2800 (1 pc)	1000 x 440 x 96	1